

Designpanel™

Perforated Plasterboard Acoustic Lining

Technical Data sheet



ASONA

Description.

Designpanel™ is a high quality press punch perforated plasterboard acoustic sheet lining for ceiling and walls. Designpanel™ is available in 1200 x 2400 mm (M2F,G2F,Q2F), 900 x 2400mm (T3L1, T3L2), 900 x 2700 (G1F,M1F,Q1F) and Tangent 14 x 4mm oval, Micro 3 x 3mm, Quadril 12 x 12mm and Globe 6mm diameter perforations in square or linear clusters. Panels are tapered edge 4 sides for superior plastering to a smooth monolithic finish. Panels painted with fine nap roller. Now incorporated with a air purification feature, Cleaneo Technology across the full Knauf-Danoline range of perforated acoustic plasterboard ceiling & wall finishes.

Application.

Designpanel™ is the ideal lining to control unwanted noise reverberation where a seamless, monolithic aesthetic is desired. Libraries, malls, halls, receptions, retail, civic buildings, galleries

Composition.

Panels manufactured from paper faced high grade reinforced natural gypsum with sound absorption felt fixed on the back.

Benefits.

- 4 sides tapered and plastered for a monolithic aesthetic.
- Perforations are press punched for a superior clean monolithic finish.
- Good sound absorption for control of reverberation noise.
- Durable finish, easy to repaint and repair.
- Ideal for a healthy comfortable indoor environment.
- Air purification feature, Cleaneo Technology

Technical Specifications

Practical Sound Absorption Coefficients: ISO 354 E-200 with 50 mm x 22 kg/m ³ glass wool overlay							
	Hz	125	250	500	1000	2000	4000
T3L1	α _p	0.45	0.70	0.80	0.70	0.70	0.80
M2F	α _p	0.55	0.60	0.60	0.50	0.50	0.50
Q2F	α _p	0.45	0.65	0.60	0.60	0.55	0.45
G2F	α _p	0.50	0.80	0.75	0.55	0.50	0.45

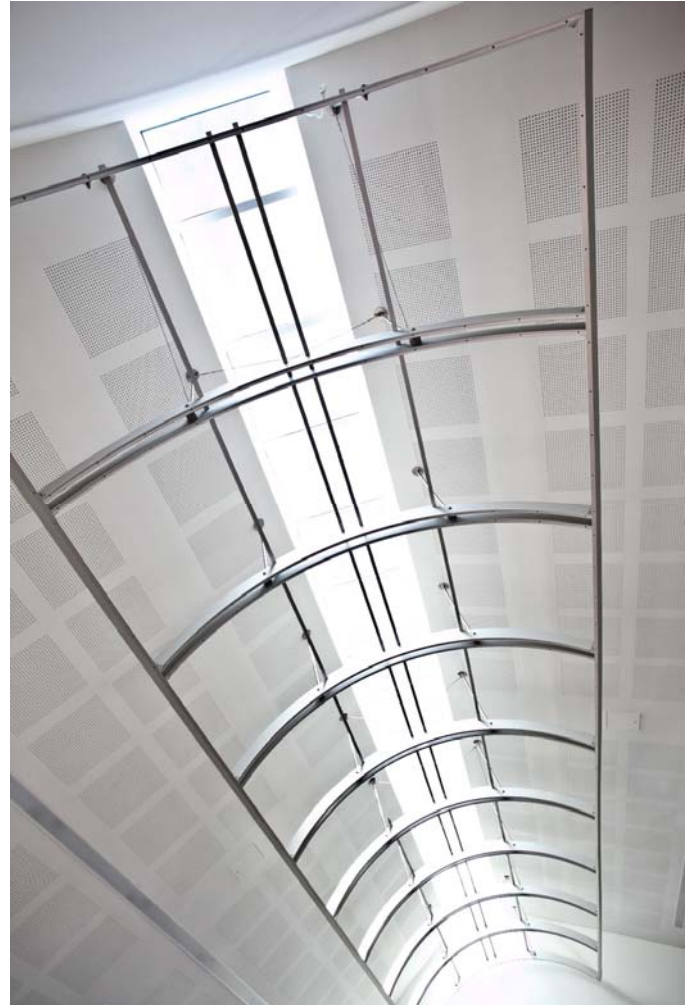

Remuera Intermediate Arts Centre

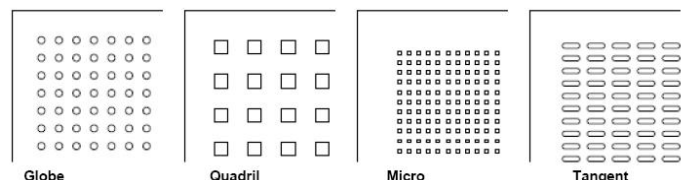
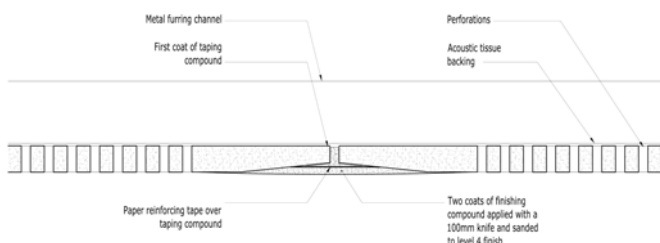

Technical Specifications

Stock Sizes and Perforations:

12.5 x 1200 x 2400 mm sheets in M2F Micro 3 x 3 mm, Q2F Quadril 12 x 12 mm, G2F Globe 6 mm ø, 12.5 x 900 x 2400 mm sheets in Tangent T3L1, T3L2, 12.5 x 900 x 2700 Globe G1F Other perforation patterns available to indent.

Colour:

Plain paper face, requires painting in situ.

Fire Reaction:

Material group number: 1S, C/VM2 / ISO 5660.1, Suitable for fire exit way and all other sprinklered & non sprinklered buildings.

Installed Conditions:

Max 90% R/H at 30°C.

Limitation:

Not for use in direct contact with moisture or in extreme humidity conditions.

Loading:

Maximum weight that can be directly integrated into the ceiling eg: lighting, A/C grill, speakers etc, shall not exceed 3kg. Greater weights shall be independently supported.

Maintenance:

Clean with vacuum, soft brush or damp cloth.

NZ Building Code:

Clause B2—durability, 15 years

Weight:

9.2 kg/m²

Installation:

Shall not commence until the building is water tight and dry. Install timber or metal furring at 300-450 mm centres, screw fix panels with 25mm bugle head gypsum screws at 200mm c/c along edges and 300mm c/c elsewhere, support butt end with furring to secure the join. Fill joins with 3 coat system and paper reinforcing tape, take care not to fill perforations. Overlay with 50 mm insulation if plenum is less than 200mm. Paint with fine nap roller. Do not spray paint.

Specification:

Ceiling/ wall lining shall be Designpanel perforated plaster-board acoustical lining as supplied by Asona Ltd, Tel: 09 525 6575, Fax: 09 525 6579. Size 12.5 x 1200 x 2400 (M2F 3 x 3 mm square perforation at 8.33 mm c/c) (Q2F 12 x 12 mm square perforation at 30mm c/c) (G2F 6 mm Ø round perforation at 15mm c/c), (13 x 900 x 2400 T3L1 & T3L2 Tangent 4 x 14mm oval perforations at 10/20 mm c/c) press punched and back laminated with grey acoustic tissue, for cavities less than 200mm overlay with 50 mm insulation blanket, panels shall be screw fixed to furring at max. 450 mm c/c. Butt joints supported, expansion joints at max 10m centres, stop to level 4 and paint with fine nap roller.

T3L2—900

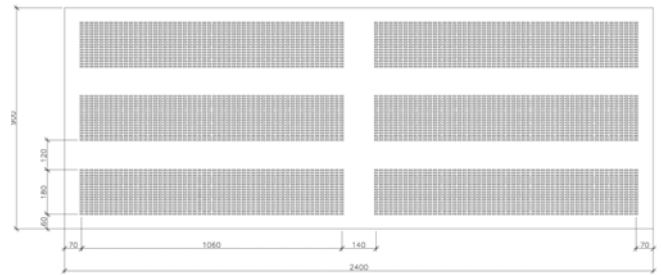

T3L1—900

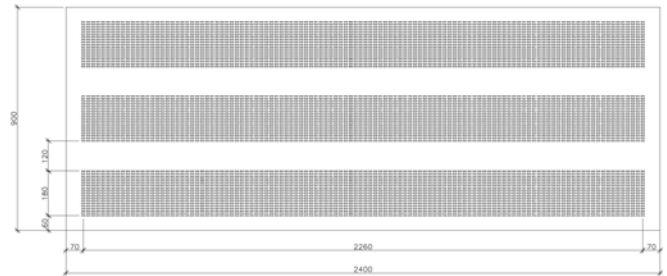

G1F—900

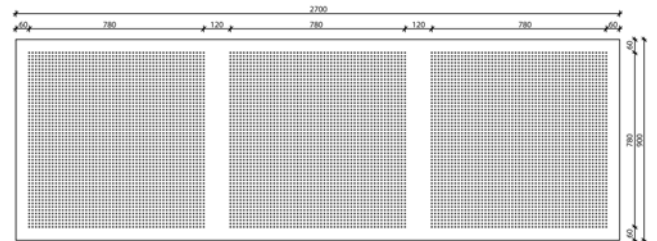

G2F-1200

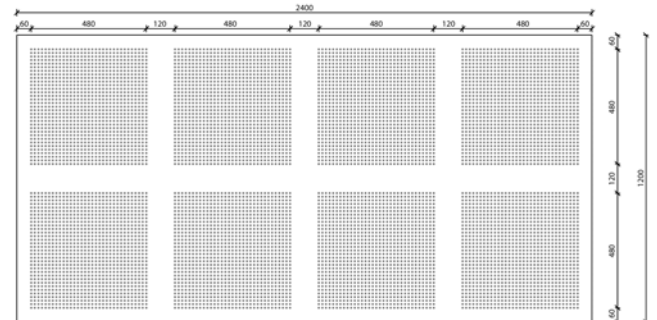

Q2F—1200

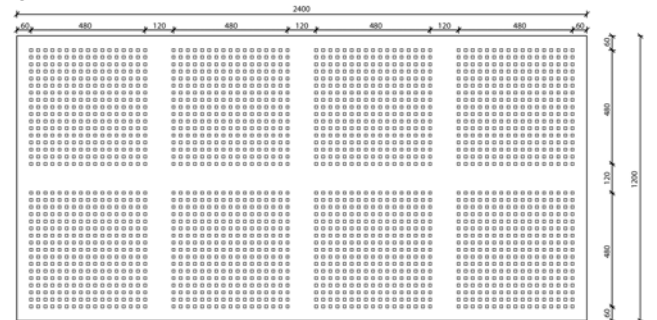

M2F—1200

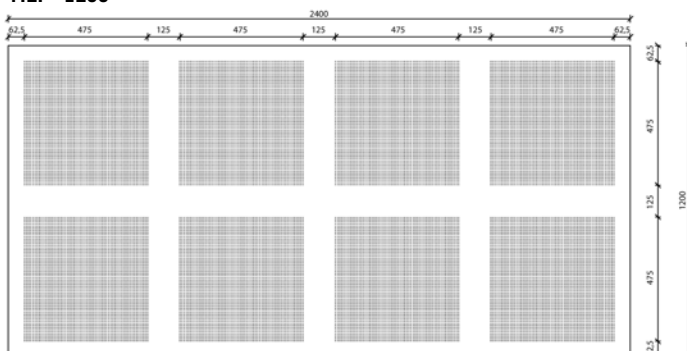

Asona Ltd

P.O Box 96-241 Balmoral,
Auckland, New Zealand
Sales: 09 525 6575
Email: info@asona.co.nz
Web: www.asona.co.nz

Factory:
Building 14, 7 Cain Road
Penrose
Auckland, New Zealand
Tel: (09) 525 6575
Fax: (09) 525 6579

© Copyright ASONA Ltd 2015
Asona, is a trade mark of Asona Ltd. Knauf-Danoline, Cleano Technology, Designpanel are all trademarks of Knauf Danoline SA, All dimensions are nominal. We reserve the right to change specifications without notice.
Ref. KD-DesignPanel—1504