

Std number of plates per panel:

| Panel Length | Number of plates |
|--------------|------------------|
| Up to 600mm | 4 |
| 1200mm | 4 |
| 1800mm | 6 |
| 2400mm | 8 |

Sectional View

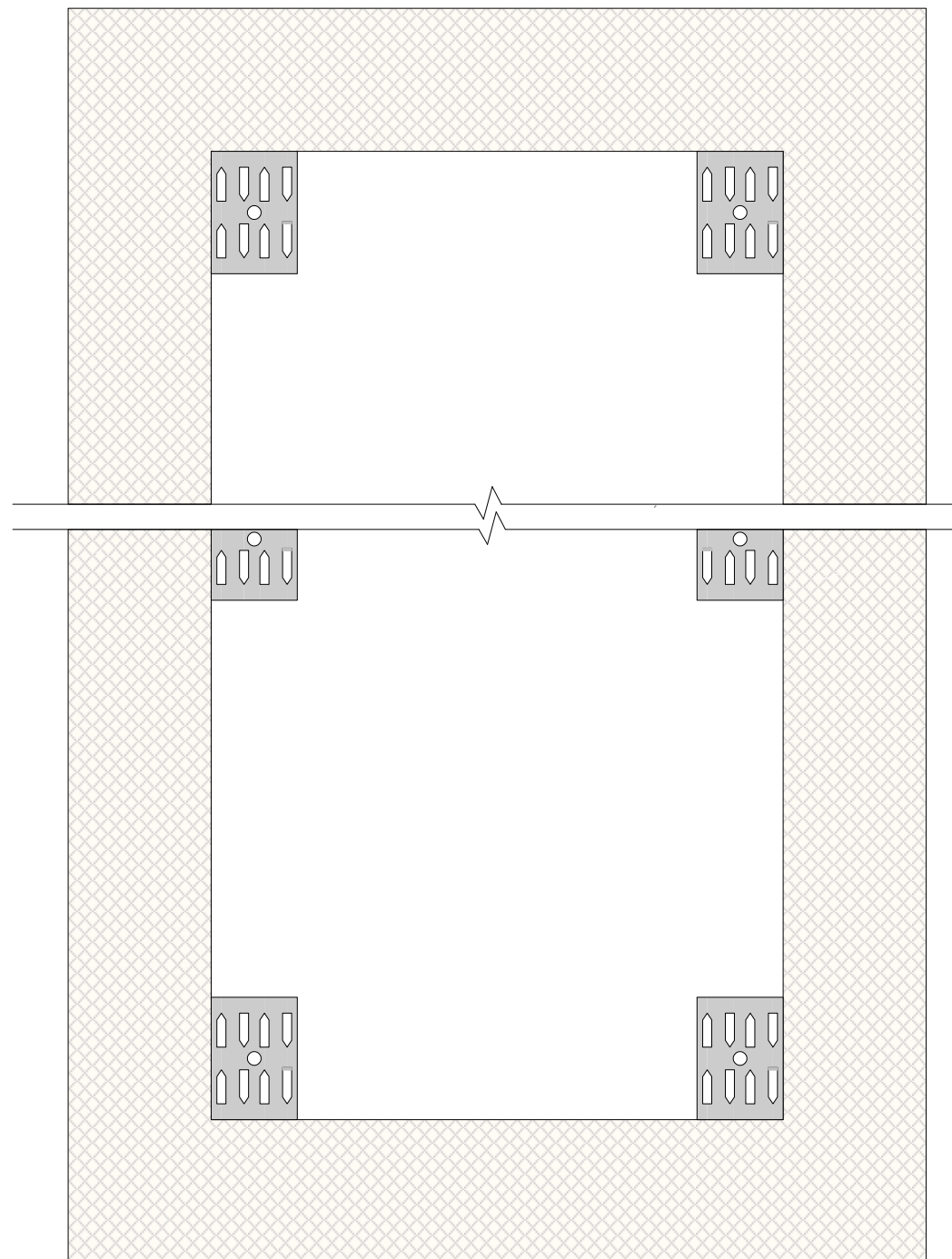

Rear View

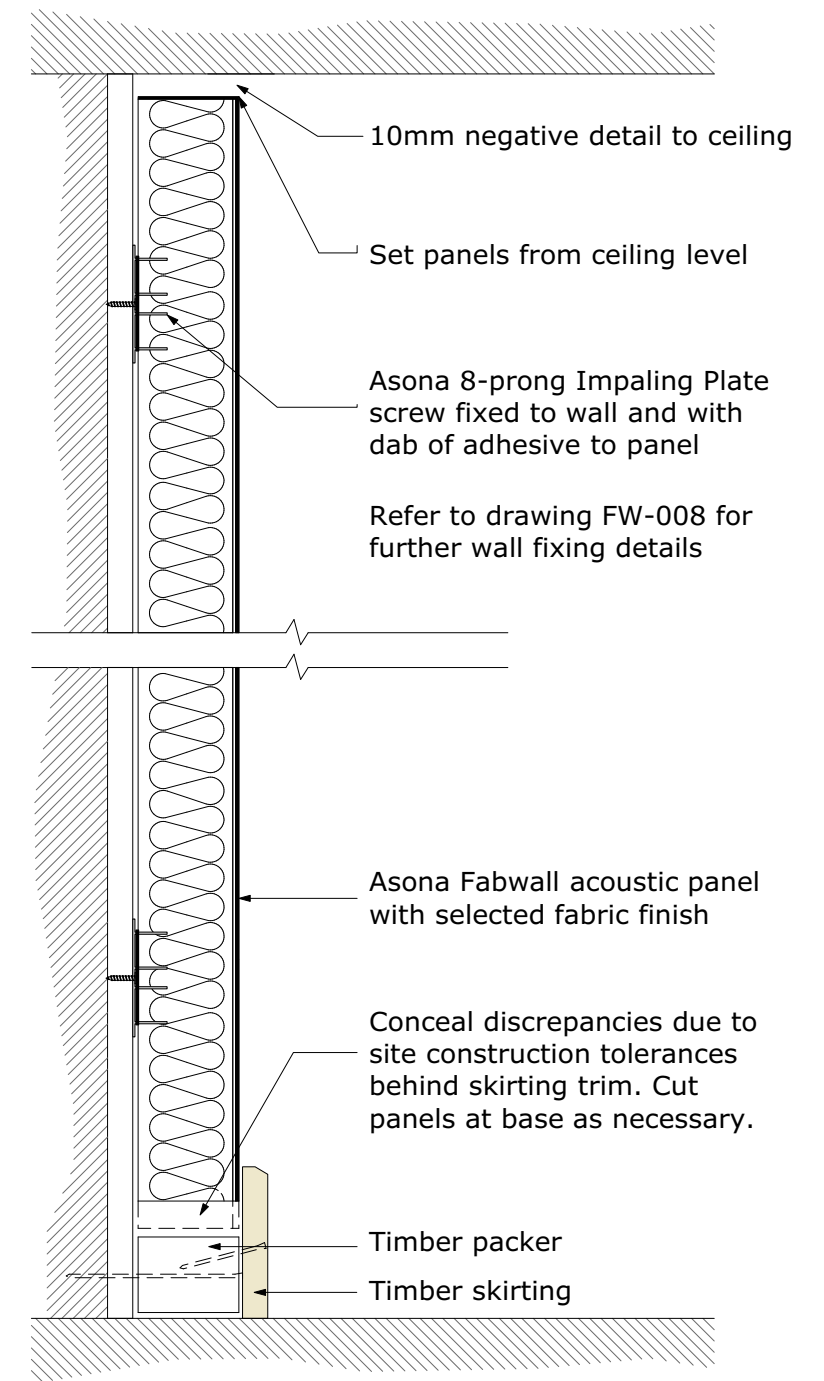

See FW-004 for Full Height Panel Head And Skirting Detail



www.asona.co.nz

info@asona.co.nz

6 Mahunga Drive, Mangere Bridge
Auckland 2022, New Zealand
Tel: +64 9 525 6575

Fabwall Standard Mounting 8-Prong Impaling Plate

Product: Asona Fabwall Acoustic Wall Panel

Customer:

Project Name:

Job Number:

APPROVED

Date: / /

Name:

Sign:

NOTES

View: Section/Rear View

Drawing Number: FW-007

Version: V4

Drawing Date: Sep 2024

Scale: N/A