

# triton fabwall bass™

TRITON FABWALL LFA LOW FREQUENCY ACOUSTIC PANELS



TECHNICAL DATA SHEET    BPIR - CLASS 2



# triton fabwall bass™

## Fabric wrapped LFA low frequency acoustic panel

### Technical Data Sheet - BPIR Class 2

Triton Fabwall Bass are specialised low frequency absorber (LFA) panels designed to control unwanted low frequency sound waves and reflect mid to high frequencies for balanced acoustics in sound studios, live rooms, and mixing rooms. Panels are factory finished with decorative fabric finish.

#### Application

Triton Fabwall Bass™ low frequency absorber panels are designed for sound studios, music rooms and large volume spaces where reverberation times below 250 Hz must be controlled.

#### Composition

Manufactured in NZ from bio-soluble glass wool absorber with proprietary LFA Sonatex™ HDL or steel interlayer\* and wrapped in a decorative fabric finishes (polyester, wool, other). Fixings from steel or aluminium.

#### Features & Benefits

- Targetted low frequency sound absorption.
- Tested systems for reliable performance
- Attractive decorative fabric finish
- Durable resilient composite construction for long life.
- Factory pre-fabricated for fast installation on site.
- Standard and custom sizes.
- Fire safe glass wool core
- Fire Group 1-S (subject to fabric / Sonatex™ selection).
- Low VOC, GreenTag certified / Level A.

#### Technical Specifications

**Sound Absorption Ratings:** 'A' Mounting per ASTM C423, ISO 354, Test reports T0817-2, T0619-8, T0609-5, T2411-28, T2411-29

| Panel    | Hz | 63   | 125  | 250  | 500  | 1000 | 2000 | 4000 |
|----------|----|------|------|------|------|------|------|------|
| 50 Bass  | ðp | 0.30 | 0.75 | 0.75 | 0.60 | 0.50 | 0.40 | 0.35 |
| 100 Bass | ðp | 0.25 | 0.90 | 0.75 | 0.45 | 0.25 | 0.20 | 0.30 |
| 150 Bass | ðp | 0.55 | 0.30 | 0.10 | 0.05 | 0.05 | 0.10 | 0.10 |
| 200 Bass | ðp | 0.75 | 0.40 | 0.50 | 0.35 | 0.10 | 0.10 | 0.10 |
| 300 Bass | ðp | 0.46 | 0.53 | 0.58 | 0.38 | 0.22 | 0.14 | 0.15 |

- ★ 50/100 Bass    Sonatex HDL interlayer
- 150 Bass        Steel interlayer
- 200/300 Bass    Sonatex HDL interlayer





### Sizes:

Absorber Thickness: 50, 100, 150, 200, 300 mm.

Panel Width: 100 to 1200 mm (width will be limited by panel thickness).

Panel Length: 100 to 3000mm mm.

Made to measure sizes available to order, consult Asona Ltd.

### Fabric Finishes:

Screen and partition fabrics from polyester, wool, hemp/linen other fabrics available to request. Fabric selection may affect fire and acoustic performance. Client supplied fabric subject to prior approval, contact Asona. Sonatex™ is available in standard white or a range of colours (refer Sonatex™ datasheet for options).

### Environmental impact:

Core from 80% recycled local glass waste. Product can be renewed.

Low VOC. <0.05.

### Maintenance:

Clean with vacuum, soft brush or damp cloth.

### Limitations:

- For interior use only, and not in direct contact with water.
- Maximum humidity/temperature 90% R/H at 30°C.
- Panels with digital printed fabric must not butt together due to image creep formed during the printing process.

### NZ Building Act

This product is not subject to a warning or ban under Section 26.

### NZ Building Code Compliance:

- B2 Durability – Clause B2.3.1 (c) (i): Asona Triton Bass Absorbers with only normal maintenance will have a minimum durability of at least 5 years when installed in accordance with manufacturer's installation requirements.
- C3 Fire – Clause C/AS2 3.4(a): Asona Triton Bass Absorbers with polyester fabric or Sonatex™ have a Fire Material Group Number 1-S by NZBC Building Product Specification Parts 8.5.4 or 8.5.5, tested in accordance with ISO 9705 or ISO 5660. (NCC BCA C1.10 clause 4, spec A2.4 clause 4. Group 1). Other fabrics 2-S, 2 and 3. Please consult Asona.

### Warranty:

15 year limited warranty against manufacturing defects.

### Weight:

2.5—4.5 kg/m<sup>2</sup>

### Tolerances:

+/-3 mm

### Specification:

Acoustic wall panels shall be Asona Triton Fabwall Bass fabric wrapped panels as manufactured by Asona Ltd Tel: 09 525 6575, email: info@asona.co.nz, module ( ) x ( ) mm, panel thickness (50)(100)(150)(200)(300)mm Bass, Fire Group 1-S (other). Selected fabric finish shall be (woven polyester) (Sonatex™) (other) and laminated to the face, all edges and a return on the back. Installed with (impaling plates and adhesive) (semi concealed side impaling brackets) (concealed split rail) by manufacturers approved fixer. Contractor shall flat pack packaging and return to Asona for reuse and register the panels with Asona Renew and Reuse product stewardship program on practical completion-NZ only.

(Asona ceiling Masterspec 5172AA specification available).

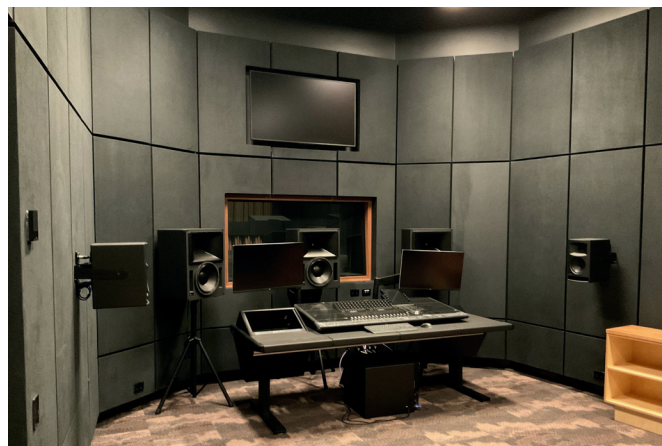

### Installation:

Triton Fabwall LFA Bass Absorber panels are a finishing trade. Installation shall not commence until the building is water tight and all work such as plastering, concrete, masonry, carpentry, painting is complete and site free of dust and debris. Not for high impact prone areas, consult Asona for impact resistant acoustic panel options.

### Mounting System:

- Wall mounting non-accessible — concealed impaling plates with adhesive fix, or semi concealed side impaling brackets.
- Wall mounting accessible — aluminium split rail.
- Ceiling mounting — direct fixed with semi concealed side impaling brackets.

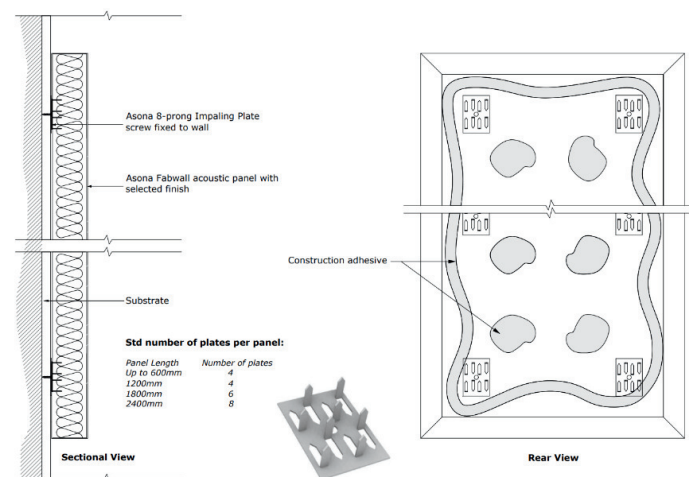

Wall mounted - non-accessible

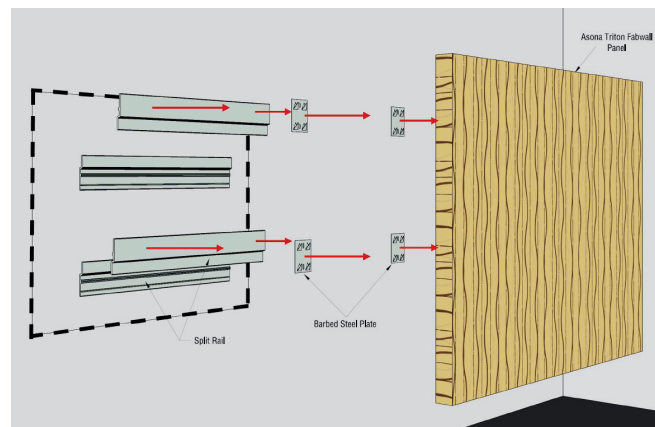

Wall mounted - accessible

